



 14,183 CPD

**FOR
LEASE
CONTACT
BROKER**

2426 AUTO PARK WAY

ESCONDIDO, CA 92029

2,500 - 5,500 SF STREET-LEVEL RETAIL/OFFICE AVAILABLE ON AUTO PARK WAY

BUSTER HOY

(619) 952-7107
buster.hoy@cast-cap.com
CA License #02123670

RYAN KING

(858) 395-7208
ryan.king@cast-cap.com
CA License #01885401

JOSH SIMMS

(619) 500-7473
josh.simms@cast-cap.com
CA License #02080261

CAST
CAPITAL PARTNERS



EXECUTIVE SUMMARY

Asking Price	Contact Broker
Address	2426 Auto Park Way, Escondido, CA 92029
Property Type	Industrial Warehouse / Office & Retail Building
Building Area	Approx. 13,084 SF (Per Title)
Land Area	Approx. 16,338 SF (0.375 AC)
APN	228-381-20-00
Year Built	1988
Zoning	M-1 Zoning: Variety of Light Industrial Uses (Processing, Assembling, Manufacturing, Storage, Warehousing and Distribution, Research and Development)
Parking	2 Spaces and 1 Shared Handicapped Space
Location	High Visibility on the Corner of Auto Park Way and Aero Way (9,389 VPD)
Accessibility	Close Proximity to Highway 78 and I-15

FLOOR PLANS

STREET LEVEL RETAIL/OFFICE

SPACE	SIZE	AVAILABILITY	PRICING
Corner Retail/Office	Approx 3,000 SF	Available Now	Contact Broker



FLOOR PLANS

STREET LEVEL RETAIL/OFFICE

SPACE	SIZE	AVAILABILITY	PRICING
Office	Approx 2,500 SF	Available Now	Contact Broker

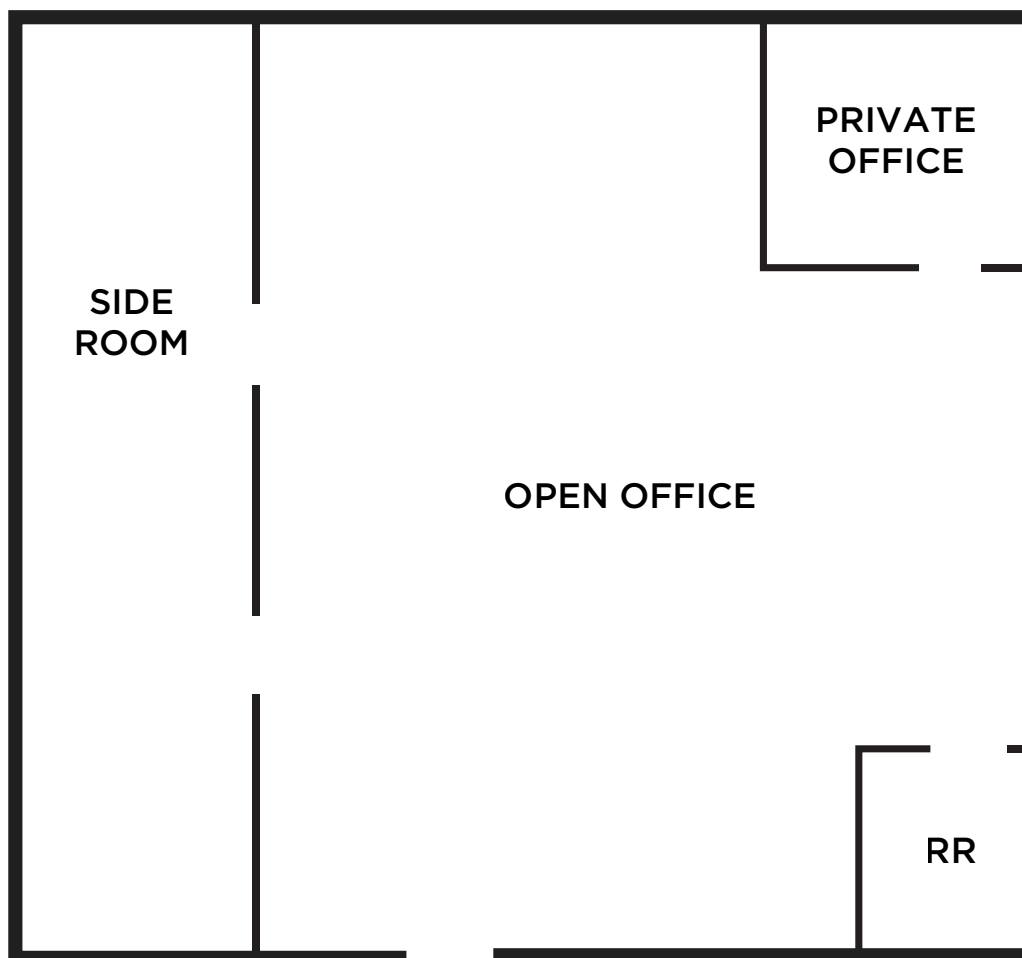

PROPERTY FEATURES

- **Floor Drain Located in Corner of Parking Lot**
- **Roll Up Doors:**
 - 14'
 - 12'5"
 - Possible Additional Roll-Up Door Installation
- **Clear Height:**
 - 21' Main Room
 - 10'5" Under Mezzanine
 - 9' in Left Part of Warehouse
- **Building Measurement Breakdown:**
 - Street Level Retail/Office: Approx 2,500 SF
 - Corner Retail/Office: Approx 3,000 SF
 - Parking Level
 - Showroom: Approx 2,500 SF
 - Warehouse: Approx 5,500 SF

LOCATION	TIME
Oceanside	20 Min - 25 Min
Encinitas	20 Min - 25 Min
La Jolla	26 Min - 30 Min
Santee	35 Min - 40 Min
Downtown	45 Min - 1 Hour
National City	20 Min

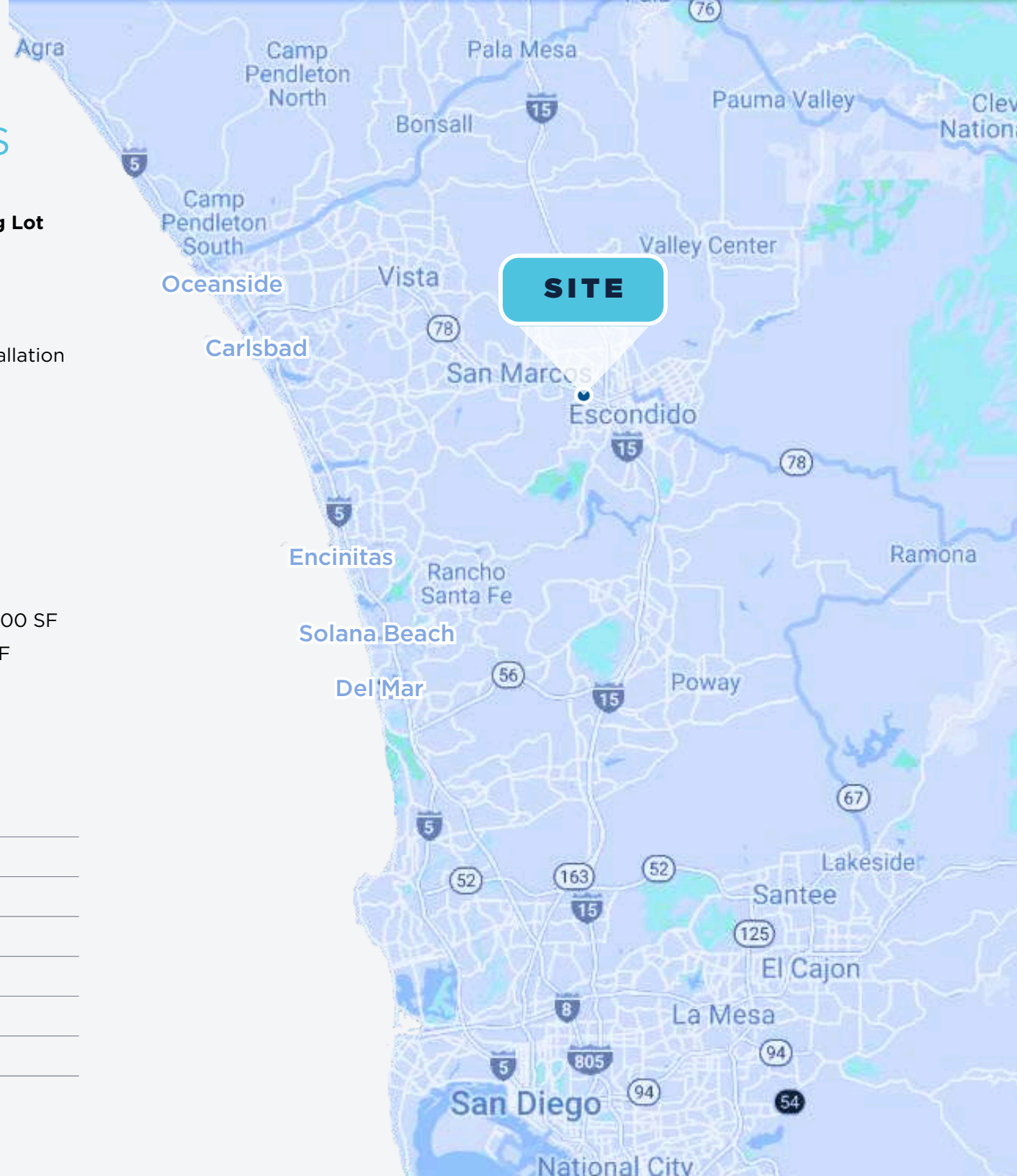

CITY OVERVIEW

Escondido is a city in San Diego County's North County region, 30 miles northeast of downtown San Diego, 15 miles from the ocean, and 40 miles from the Mexican border. The city occupies a shallow valley ringed by rocky hills. Incorporated in 1888, it is one of the oldest cities in San Diego County.

DEMOGRAPHICS



242,567
Population



\$2.9B
Consumer Spending



\$100,618
Average Household Income



10,502
Businesses



78,315
Households





CAST

CAPITAL PARTNERS

5090 Shoreham Place Suite 100
 San Diego, CA 92122
 information@cast-cap.com
 619-308-6680

www.Cast-Cap.com

BUSTER HOY
 (619) 952-7107
 buster.hoy@cast-cap.com
 CA License #02123670

RYAN KING
 (858) 395-7208
 ryan.king@cast-cap.com
 CA License #01885401

JOSH SIMMS
 (619) 500-7473
 josh.simms@cast-cap.com
 CA License #02080261

This information above was obtained from sources deemed reliable. No warranties or representations, expressed or implied, are made as to the accuracy of the information contained herein, and same is submitted subject errors, omissions, change of price, rental or other conditions, withdrawal without notice, and to any special listing conditions imposed by our principals. This information is given with the understanding that all negotiations relating to the purchase, renting or leasing of the property described herein shall be conducted through CAST Capital Partners."